

## F582/F584 MAINTENANCE MANUAL

### 1. DESCRIPTION AND OPERATION

#### 1.1 DESCRIPTION

The F582/F584 Swivel Disconnects are designed to provide the ability to custom build a Nozzle or Hydrant Coupler system to meet a customer's requirements. All Parker/Thiem Swivels utilize a ball lock concept and all F582/F584 models are equipped with a newly designed heavy duty coupling.

#### 1.2 OPERATION (Refer to Cutaways Page 7 or 9)

To Disengage:

- 1.2.1 Lift the safety lock ring (Item 3) out of its groove and slide back to the body shoulder.
- 1.2.2 Back out the two locking screws (Item 7) until the sleeve (Item 4) is free to move.
- 1.2.3 Disengage the coupling from the swivel body by pulling them apart.

To Re-Engage the swivel body and coupling:

- 1.2.4 Slip the coupling into the swivel body assembly.
- 1.2.5 Slide the sleeve (Item 4) forward (this cannot be accomplished until the coupling and swivel body are fully engaged).
- 1.2.6 Slide the safety lock ring (Item 3) forward until it positions itself in its locking groove.
- 1.2.7 Screw the two locking screws (Item 7) into their locking slot.

## 2. MODEL VARIATIONS

Table of Modifications – Continued  
F582 (2-1/2" Swivel Assy.)

F582 (2-1/2") Suffix			
Letter	Weight Lbs.	(KG)	Description
A	1.69	.76	Body Assy. Complete 2-1/2" Female NPT Inlet
B	1.69	.76	Body Assy. Complete 2-1/2" Female BSP Parallel Inlet
C	2.00	.90	Body Assy. Complete 3" Female NPT Inlet
D	1.88	.85	Body Assy. Complete 2" Female NPT Inlet
E	.75	.34	Alum. Coupling Assy. 2-1/2" with Parker/Thiem Flange
F	2.00	.90	Body Assy. Complete 3" Female BSP Parallel Inlet
G	6.75	3.04	Elbow Assy. 90° Double Swivel
H	1.10	.50	Alum. Coupling Assy. 2-1/2" w/MS Flange & Hardware
J	.45	.20	Male Coupling 2-1/2" (Formerly F501)
K	3.25	1.47	Body Assy. Complete 4" Female NPT Inlet
M	.06	.03	Strainer, 40 Mesh (cannot be used alone)
N	.06	.03	Strainer, 60 Mesh (cannot be used alone)
P	.06	.03	Strainer, 100 Mesh (cannot be used alone)
T			Body Assy., Camlock 3" Female
U			Body Assy., Camlock 4" Male
V			Body Assy., Complete 3-1/2" Female NPT Inlet
X	1.88	.85	Body Assy., Complete 2" Female BSP Parallel Inlet
Y	.75	.34	Alum. Coupling Assy. 2-1/2" w/J.C. Carter Flange

Meggitt Fuelling Products  
Avery-Hardoll  
Whittaker Controls

**Table of Modifications  
F584 (3" Swivel Assy.)**

F584 (3") Suffix			
Letter	Weight Lbs.	(KG)	Description
A	2.12	.95	Body Assy. Complete 2-1/2" Female NPT Inlet
B	2.12	.95	Body Assy. Complete 2-1/2" Female BSP Parallel Inlet
C	2.75	1.24	Body Assy. complete 3" Female NPT Inlet
D	2.18	.98	Body Assy. Complete 2" Female NPT Inlet
E	2.69	1.21	Body Assy. Complete 3" Female BSP Parallel Inlet
F	TBD		Body Assy. Complete 3" Nat'l. Valve Type End Connection
H	1.10	.50	Alum. Coupling Assy. 3" w/MS Flange & Hardware
L	1.06	.48	Alum. Coupling Assy. 3" with Parker/Thiem Flange
M	.06	.03	Strainer, 40 Mesh (cannot be used alone)
N	.06	.03	Strainer, 60 Mesh (cannot be used alone)
P	.06	.03	Strainer, 100 Mesh (cannot be used alone)
S	1.70	.77	Alum. Coupling Assy., 3" 45° Elbow with Parker/Thiem Flange
W	1.70	.77	Alum. Coupling Assy. 3" 45° Elbow w/J.C. Carter Flange
Y	1.00	.45	Alum. Coupling Assy. 3" w/J.C. Carter Flange

### 3. LEADING PARTICULARS

#### 3.1 SERVICE FLUIDS

All Commercial Automotive and Aviation Fuels

#### 3.2 PRESSURES

1. Working 0-200 PSI
2. Proof 300 PSI

#### 3.3 TEMPERATURES

1. Ambient -65° F to 160° F
2. Fluid -65° F to 130° F

### 4. TROUBLE SHOOTING

Trouble	Cause	Repair
Leakage	Damaged Quad Ring or Packing on Coupling	Replace Quad Ring Item 10 (F582), 9 (F584) or Packing Item 11 (F582) 10 (F584)

### 5. DISASSEMBLY – Refer to Illustrated Cutaway View as a Guide

5.1 Repeat disengagement instructions, Section 1, B.1

5.2 Replace seals as necessary on coupling

5.3 Remove retaining ring from the end of the body assembly and slide sleeve off. Care should be taken to avoid losing balls (Item 6).

### 6. CLEANING

Immerse and wash all metallic parts in commercially available cleaning solvent. Use a stiff brush to remove any stubborn accumulations of dirt and/or foreign matter. Dry with a clean, lint free cloth or use compressed air.

### 7. CHECK/INSPECTION

Visually check all parts, using a strong light, for nicks, cracks, cuts, warpage, corrosion, crossed threads, chafing, scoring or any other obvious defects which could impair efficient operation.

### 8. REPAIR

Minor repairs that do not affect original function may be accomplished using standard shop practices.

### 9. ASSEMBLY – Refer to Illustrated Parts Break as a Guide

9.1 Use a liberal amount of petrolatum on bearing holes and install ball bearings.

9.2 Slide sleeve over bearing and put snap ring in place.

9.3 Repeat re-engagement instructions from Section 1, B.2

## Illustrated Parts Breakdown F582

Item	QTY. REQ'D	Part Number	Description	Where Used
1	1		Body Assembly	A,B,C,D,F,K,T,U,V,X (REF)
2A	1	1429-585784-2	Body 2-1/2" NPT Female	A
2B	1	1429-585784-4	Body 2-1/2" BSPPL Female	B
2C	1	1429-595208-1	Body 3" NPT Female	C
2D	1	1429-585784-1	Body 2" NPT Female	D,T
2E	1	1429-595208-2	Body 3" BSPPL Female	F
2F	1	1429-586130	Body 4" NPT Female	K,U
2G	1	2642838	Body 3-1/2" BSPPL Female	V
2H	1	1429-585784-5	Body 2" BSPPL Female	X
3	1	2803016-101	Safety Ring	A,B,C,D,F,G,K,T,U,V,X
4	1	1429-585783	Sleeve	A,B,C,D,F,G,K,U,U,V,X
5	1	MS16626-1350	Retaining Ring	A,B,C,D,F,G,K,U,U,V,X
6	8	MS19060-26	Ball Bearing	A,B,C,D,F,G,K,U,U,V,X
7	2	NK500A416-7M	Screw, Lock	A,B,C,D,F,G,K,U,U,V,X
8	2	AN960-416	Washer	A,B,C,D,F,G,K,U,U,V,X
9	1		Elbow Assembly	G (REF)
10	1	2823082-101	Elbow	G
11	1	2661058A042	Packing	E,Y
12	1	Q4231-366Y	Quad Ring	E,G,H,J,Y
13	1	2803082-101	Seal, Back-up	E,G,H,J,Y
14	2	2803015-101	Ring, Bearing	E,G,H,J,Y
15	1		Coupling Assembly	E (REF)
16A	1	2803361-101	Coupling 2-1/2"	E
16B	1	2823085-101	Coupling 2-1/2" w/MS Flange	H
16C	1	2823077-101	Coupling 2-1/2" w/2-1/2" Male NPT	J
16D	1	2823102-101	Coupling 2-1/2" w/J.C.Carter Flange	Y
17A	1	2672020-1	40 Mesh Strainer	M (Suffix cannot stand alone)
17B	1	2672020-2	60 Mesh Strainer	N (Suffix cannot stand alone)
17C	1	2672020-3	100 Mesh Strainer	P (Suffix cannot stand alone)
17D	1	1426-586228	100 Mesh Strainer	H (Only)
18	1	2706133-104	Close Nipple, 2" NPT	T
19	1	200D	2" Female Camlock Fitting	T
20	1	400-F-AL	4" Male Camlock Coupling	U
not shown 21	1	7-449-6	Gasket	H
not shown 22	6	AN960-516	Washer	H
not shown 23	6	AN509-516R18	Screw	H
not shown 24	6	AN365-524	Nut	H

# Meggitt Fuelling Products

Avery-Hardoll  
Whittaker Controls

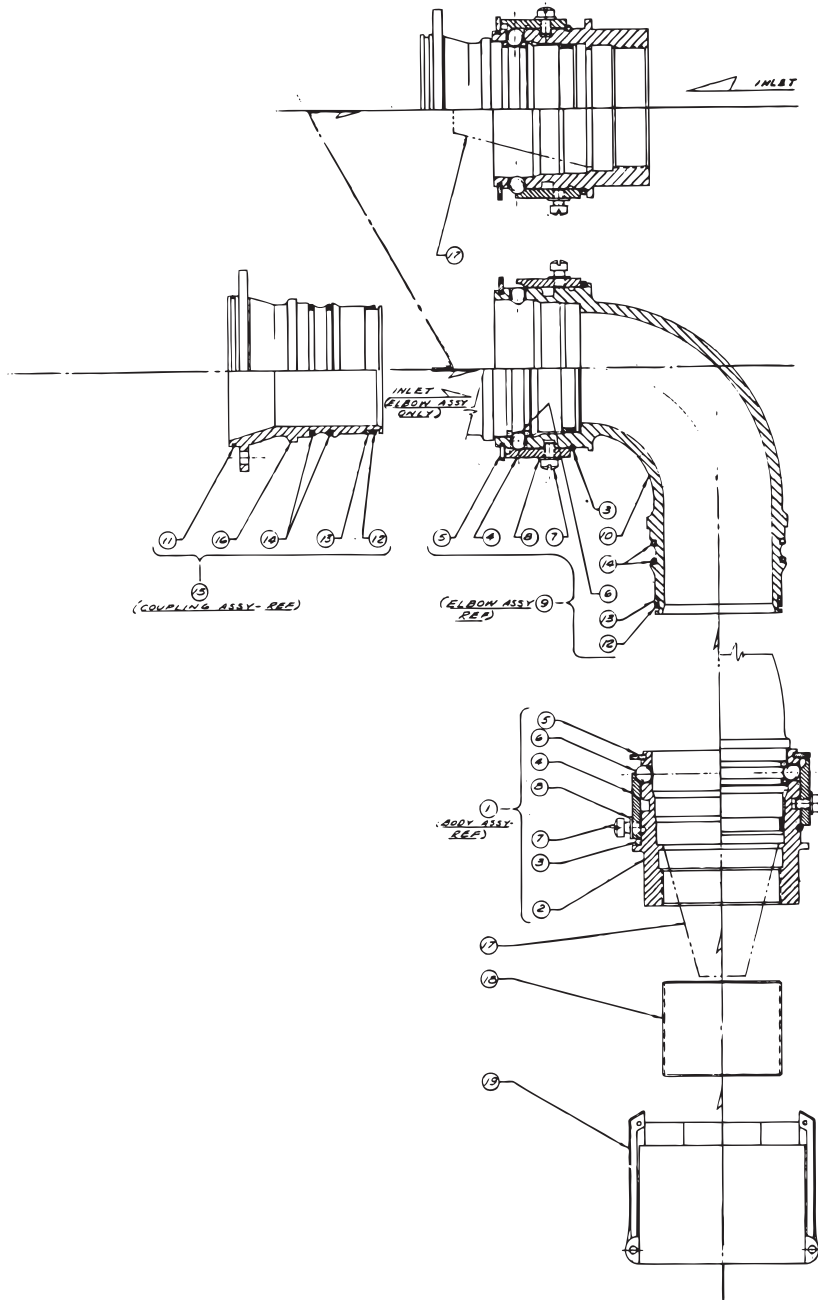

Meggitt Fuelling Products  
Avery-Hardoll  
Whittaker Controls

Illustrated Parts Breakdown  
F584

Item	QTY. REQ'D	Part Number	Description	Where Used
1	1		Body Assembly	A,B,C,D,E,F (REF)
2A	1	2793388-101	Body 2-1/2" NPT Female	A
2B	1	2793388-104	Body 2-1/2" BSPPL Female	B
2C	1	2793388-105	Body 3" NPT Female	C
2D	1	2793388-102	Body 2" NPT Female	D
2E	1	2793388-106	Body 3" BSPPL Female	E
2F	1	27020241	Body 3" National Valve	F
3	1	2793393-101	Safety Ring	A,B,C,D,E,F
4	1	2681559	Sleeve	A,B,C,D,E,F
5	1	5108-400	Retaining Ring	A,B,C,D,E,F
6	8	MS19060-26	Ball Bearing	A,B,C,D,E,F
7	2	NK500A416-7	Screw, Lock	A,B,C,D,E,F
8	2	AN960-416	Washer	A,B,C,D,E,F
9	1		Coupling Assembly	H,L,S,W,Y (REF)
10A	1	2661058A042	Packing	H,L,S
10B	1	2661058A151	Packing	W,Y
11	1	Q4235-366Y	Quad Ring	H,L,S,W,Y
12	1	2793392-101	Back-up Seal	H,L,S,W,Y
13	2	2793391-101	Bearing Ring	H,L,S,W,Y
14A	1	2823108-101	Coupling 3" w/MS Flange	H
14B	1	2793390-101	Coupling 3"	L
14C	1	2823188-101	Coupling 3" w/45° Elbow	S
14D	1	2823188-102	Coupling 3" w/45° Elbow J.C. Carter Flange	W
14E	1	2823103-101	Coupling 3" w/J.C. Carter Flange	Y
15A	1	2681633-1	40 Mesh Strainer	M (Suffix cannot stand alone)
15B	1	2681633-2	60 Mesh Strainer	N (Suffix cannot stand alone)
15C	1	2681633-3	100 Mesh Strainer	H,P (Suffix cannot stand alone)
not shown 16	1	7-449-6	Gasket	H
not shown 17	6	AN960-516	Washer	H
not shown 18	6	AN509-516R18	Screw	H
not shown 19	6	AN365-524	Nut	H

# Meggitt Fuelling Products

Avery-Hardoll  
Whittaker Controls

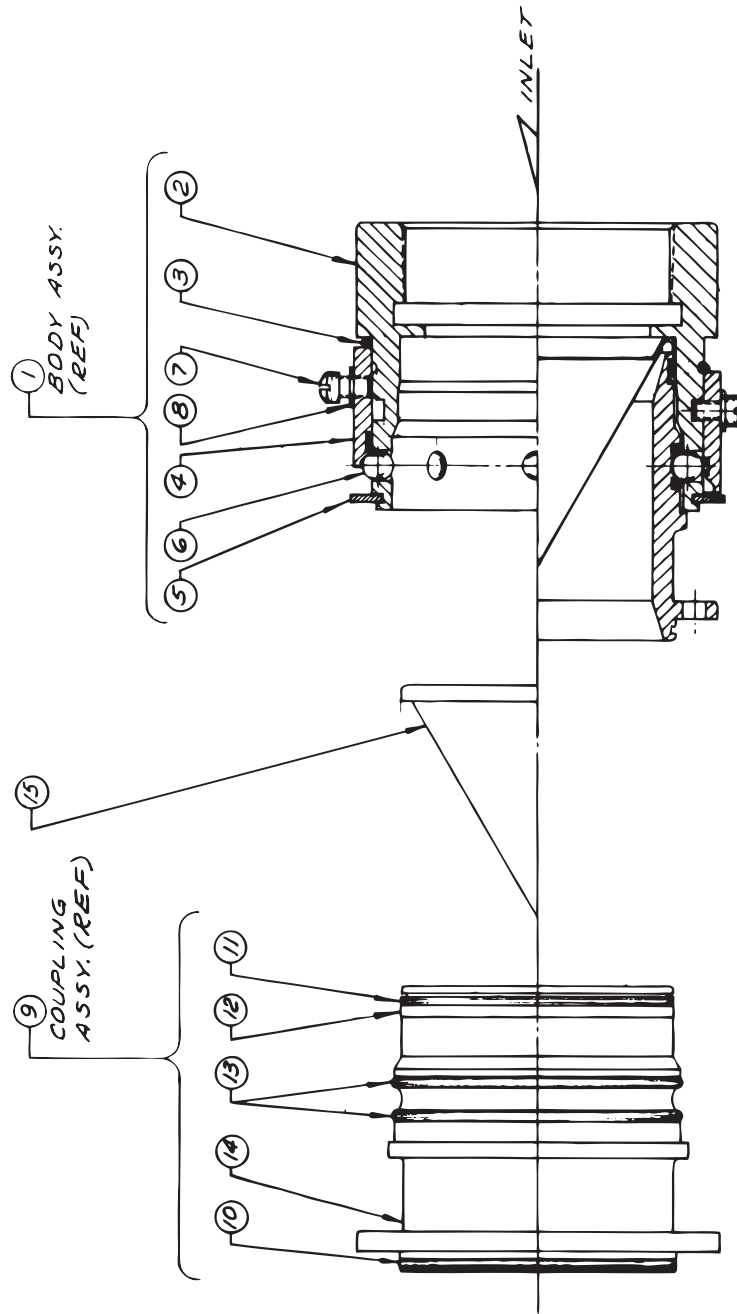

Avery-Hardoll  
Holland Way  
Blandford Forum  
Dorset DT11 7BJ  
UK

Whittaker Controls  
12838 Saticoy St  
North Hollywood  
California 91605-3505  
USA

Tel: +44 (0) 1258 486600  
Fax: +44 (0) 1258 486601

Tel: +1 818 765 8160  
Fax: +1 818 759 2194

[www.meggittfuelling.com](http://www.meggittfuelling.com)

[www.wkr.com](http://www.wkr.com)  
[meggitt.com](http://meggitt.com)

**MEGGITT**